

Redefine Your Vibrancy, In Style.

canopy
by Hilton™

OSAKA | UMEDA



WELCOME TO Canopy by Hilton Osaka Umeda

Where Osaka's vibrant energy collides with serene green urban parkland. Nestled in the Grand Green Osaka district, our hotel channels the dynamic, playful spirit of the city, in big and small detail. Step through an entrance inspired by a takoyaki hotplate, marvel at kushikatsu-themed lighting in our restaurant, and explore spaces that whisk tradition up with modern flair. Every corner is a celebration of Osaka's culture and creativity, from artful décor to the globally inspired flavors served across our unique dining outlets.

Relax in one of our 308 spacious guest rooms, including 53 suites, designed to capture Osaka's bright and artistic vibes. With welcoming communal spaces, authentic curated local experiences, and three dining venues showcasing dynamic and innovative flavors, we are your gateway to the soul of Umeda.

Located just a 7-minute walk from JR Osaka Station, Canopy by Hilton Osaka Umeda offers effortless access to Kansai's treasures, including Kyoto and Nara. Heading to or from KIX or Itami airports, or maybe the shinkansen? Convenient as convenience can be. Legs are for walking, so stretch them to nearby shops, Umeda eats or maybe a peak at the Osaka Castle. Whether soaking up the city's buzz or retreating to the green oasis around our hotel, your Osaka adventure starts here. "Kite-ya!"



Canopy Bike

Hop on a Canopy Bike and pedal your way through Osaka's vibrant streets and hidden gems. Designed for sustainable yet authentic adventures, our rental bikes let you explore the city like a local Osaka-jin. Need inspiration? Our concierge has curated special itineraries to guide you to must-see sights and off-the-beaten-path hideaways. Adventure awaits—just grab a bike and go!



Cycling Map

GENERAL INFORMATION

“Redefine Your Vibrancy, In Style”

Canopy by Hilton Osaka Umeda is located on the 1st floor and from the 10th to the 25th floors of the North Tower of "GRAND GREEN OSAKA." It serves as a gathering place for curious young people, creators, innovators, and adventure seekers, offering a unique community space inspired by Osaka's history and culture, along with exciting dining experiences.



Canopy Corner Suite (63m²)



Premium View Room (32m²)

LOCATION

Located within the North Tower of "GRAND GREEN OSAKA," just a 7-minute walk from JR Osaka Station, this is an excellent location ideal for both business and tourism. Enjoy vibrant shopping, dining, entertainment, and cultural experiences. By car, it takes just 2 minutes from JR Osaka Station via the Hanshin Expressway Route 11 Ikeda Line, providing excellent access not only to major airports and Shin-Osaka Station, but also to the entire Kansai region.

	Drive
• Kansai International Airport (KIX):	50mins
• Osaka International Airport (ITM):	20mins
• Shin-Osaka Station (Shinkansen):	12mins
• Osaka Station (JR):	7mins
• Osaka Umeda Station (Hankyu-line, Hanshin-line):	7mins
• Namba Station (Osaka Metro):	15mins
• Shinsaibashi Station (Osaka Metro):	15mins

HOTEL FEATURES

- A total of 308 spacious guest rooms, including 53 suites, embody the bright vibes of Osaka
- The fitness center, located on the 12th floor, boasts exceptional views
- A pet-friendly café on the 1st floor with 74 seats (54 indoors / 20 on the terrace)
- All-day dining on the 11th floor with 99 seats (85 indoors / 14 in private dining)
- Bar & lounge with an outdoor terrace on the 11th floor with 126 seats (80 indoors / 46 on the terrace)
- Entire hotel is non-smoking
- 3 meeting facilities
- Canopy bike for free rent
- Canopy retail wall — offering hotel-branded items and local souvenirs
- Seasonal guide — showcasing local hotspots, hip restaurants, boutiques, museums and much more!

GUEST ROOM SERVICES

- Requests for feather pillows, anti-allergy pillows, baby cribs, and more can be accommodated
- Express service, laundry service
- Nightly turndown service
- Room service

GUEST ROOM FACILITIES (STANDARD ROOM)

- 55-inch widescreen television and movie channels
- Wired and wireless internet access
- Equipped with a shower booth, washbasin, and separate toilet
- Electronic control panel (Room temperature)
- Bluetooth Speaker
- Iron and ironing board
- Electronic safe
- Mini-bar, coffee maker
- Writing Desk, Coffee Table
- Coffee-Tea facility
- Multi user adaptor
- Refrigerator, and more

ROOM TYPE

- Canopy Room : 32m²
- Premium Room : 32m²
- Canopy View Room : 32m²
- Premium View Room : 32m²
- Canopy Corner Suite : 63m²
- Canopy Osaka Suite : 95m²
- Canopy Panorama View Suite : 127m²
- Accessible Room : 32m²



GUEST ROOM INFORMATION

- 100% non-smoking rooms
- Check-in 3pm, Check-out 11am
- Accessible rooms and 19 connecting rooms are available
- Pet friendly rooms are available

OTHER HOTEL SERVICES

- Multi-lingual staff, message service, luggage storage and delivery service

RESTAURANTS & BAR

Bean there, UMEDA



Your go-to coffee spot in the heart of Umekita.

On the ground floor and blending seamlessly with the lush green parkland of Umekita, Bean there, UMEDA serves up perfectly brewed pour-over coffees, using locally roasted blends crafted for the authentic Osaka caffeine experience. Enjoy artisanal sandwiches, bagels, and pastries with your coffee, whether you're chilling-out in the aircon, unwinding on the pet-friendly terrace, or grabbing our signature BtU blend to-go. From morning brews to evening aperitivos, BtU is the perfect spot to recharge and connect.



CC: CARBON COPY



Global flavors, small plates, big moments.

At CC:, dining is a journey of the world's flavors on stunning Japanese small plate ko-zara. Begin the day with an energizing breakfast buffet, explore curated semi-buffet lunches, or savor globally inspired dinners. Featuring live cooking stations and dishes blending tapas, izakaya, mezza, and more, CC: transforms every meal into a dynamic exploration of taste and texture.

CC: Your friends CC: Flavors to your meal

CC: Memories instead of souvenirs BCC: Your wallet ;)



CC:

!JaJa!Bar



Full-throttle fun, Osaka-style!

Step into !JaJa!, where the city's electric and dynamic nightlife comes alive under the canopy. From outside terrace vibes to craft drinks that hit all the right notes, it's your ticket to Osaka's boldest flavors and biggest energy. Sip on funky local beers, signature cocktails, or daring wines, and pair them with playful bites that remix classic Osaka street food. With live music, smart ball games, and a buzzing terrace scene, !JaJa! isn't just a bar—it's Osaka's heartbeat turned up to eleven.



FITNESS CENTER

Break a sweat at our 12th-floor fitness center, open 24/7 and equipped with cutting-edge Technogym gear to keep your workouts fresh and effective. Look up and let the ceiling's playful design, inspired by the rhythm and energy of Osaka's comedians, motivate you to keep moving. Whether it's cardio, weights, or a quick session with our fitness trainer, you'll find fitness with a twist of authentic Osaka humor here. Sweat and smile!

- Open 24hours
- Fitness Trainer
- Cardio Equipment / Weight Equipment



MEETINGS & EVENTS

Host inspired gatherings in spaces that blend the elegance of Osaka Castle with a fresh, modern vibe. Whether it's a corporate meeting, creative workshop, or an elegant reception, our versatile venues offer a seamless mix of tradition, sophistication, and cutting-edge technology.

Designed with the spirit of Osaka Castle in mind, our meeting spaces exude a refined charm while providing the latest amenities, including retractable projectors, advanced sound systems, and high-speed Wi-Fi.

HIROMA

Spanning 100m², HIROMA is a modern, versatile venue inspired by Osaka Castle's architectural grandeur. With a large screen, wall-mounted whiteboard, and wireless conferencing systems, it's perfect for events of up to 100 guests, from formal presentations to lively celebrations.

Meeting Studio

The 55m² Meeting Studio combines functionality with breathtaking views of JR Osaka Station and Umekita Park. Equipped with state-of-the-art conferencing tools and an open, light-filled design, it's ideal for creative, free-flowing discussions and brainstorming sessions.

Boardroom

With its 65m² layout, the Boardroom is tailored for focused corporate meetings and intimate discussions. Featuring top-tier conferencing equipment, a cozy adjacent sofa area, and a cloakroom, it offers a polished yet relaxed setting.

Pre-function Room

Connect and unwind in the open two-story atrium linking HIROMA and the Meeting Studio. Perfect for pre-event receptions, cocktail hours, casual breaks or break-outs, this elegant space offers stunning views of JR Osaka Station, Umekita Park, and the sunset, elevating every gathering into a memorable occasion.



HIROMA



MEETING STUDIO



BOARDROOM

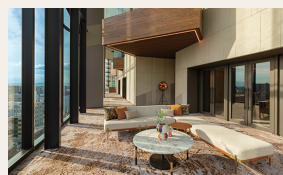

Pre-function Room

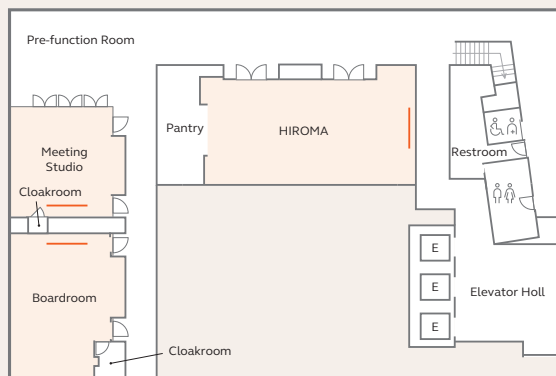

ROOM NAME	TOTAL AREA (m ²)	WIDTH (m)	LENGTH (m)	HEIGHT (m)	CAPACITIES						
					Theater	Classroom	Seating	Reception	U-Shape	Hollow Square	Boardroom
HIROMA	100	6.8	13.5	3	100	42	36	60	24	36	20
Meeting Studio	55	7.5	6.9	3	—	—	10	—	—	—	10
Boardroom	65	7.5	9.4	3	—	—	14	—	—	—	14

LOCATION

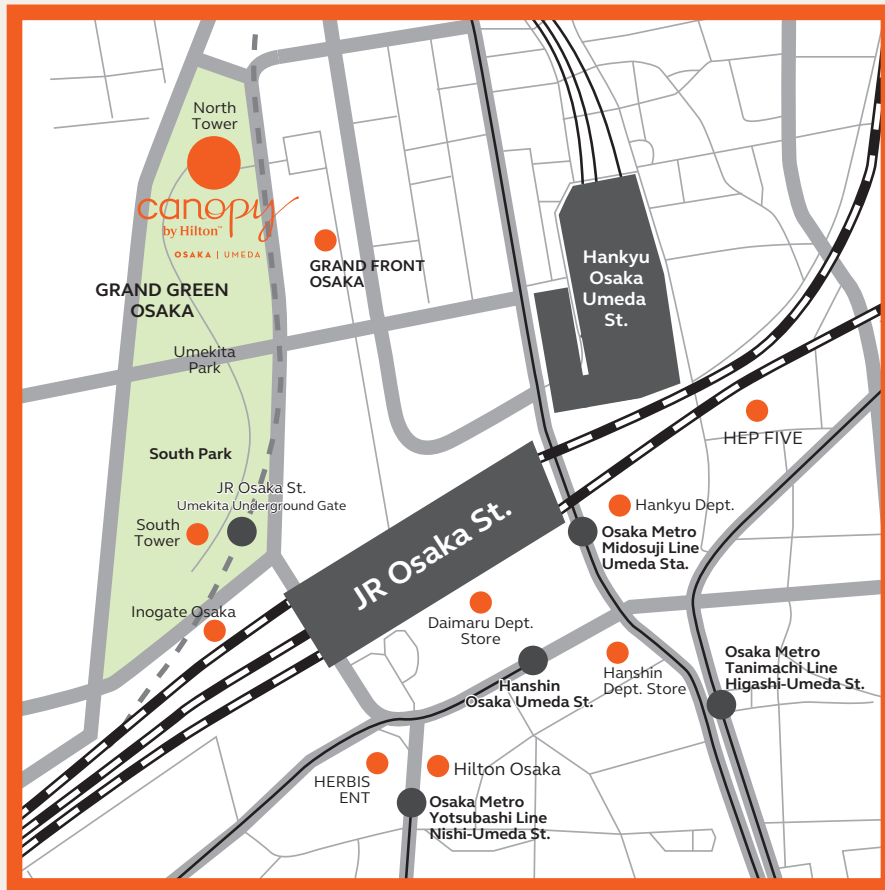

Canopy by Hilton Osaka Umeda

Grand Green Osaka North Tower
6-38 Ofukacho, Kita-ku, Osaka 530-0011 Japan

canopyosaka.com

Tel: +81 6 7658 5300

Fax: +81 6 7658 5304

Email: OSAPY_Info@hilton.com



Website



Facebook



Instagram



LINE



Running Map



3D Map

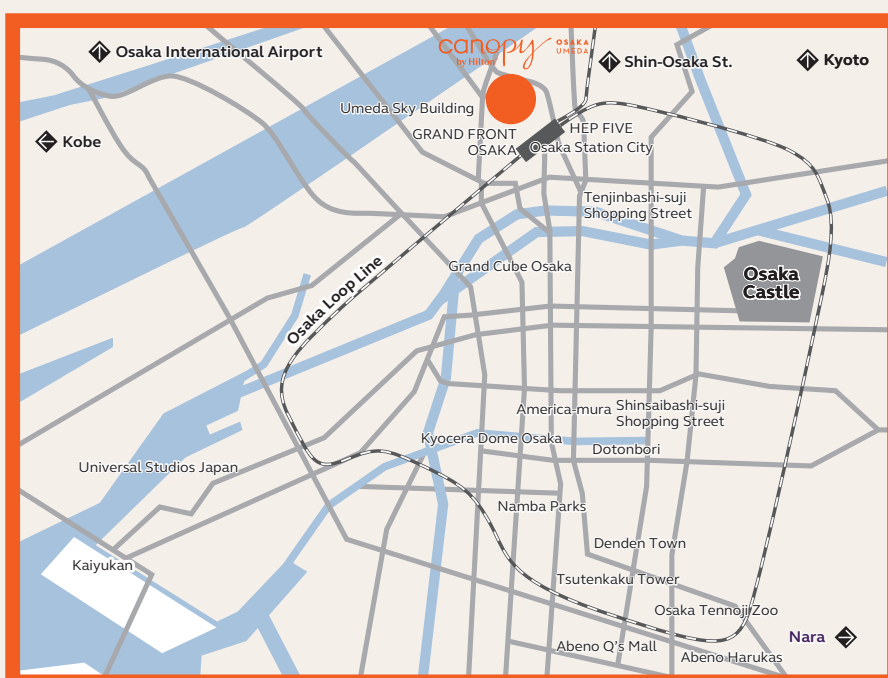

What is nearby?

GRAND FRONT OSAKA	0.1km
Umeda Sky Building	0.2km
Osaka Station City	0.4km
HEP FIVE	0.7km
Tenjinbashi-suji Shopping Street	2.4km
Grand Cube Osaka	3km
Osaka Castle	4.2km
America-mura	4.4km
Dotonbori	4.8km
Namba Parks	5.1km
Tsutenkaku Tower	6.6km
Kyocera Dome Osaka	7km
Abeno Harukas	9km
Universal Studios Japan	9.5km
Osaka Aquarium KAIYUKAN	12km